

CAVIUS Photoelectric Smoke Alarms

TENANT TROUBLE SHOOTING GUIDE

97mm Mains Powered Smoke Alarm

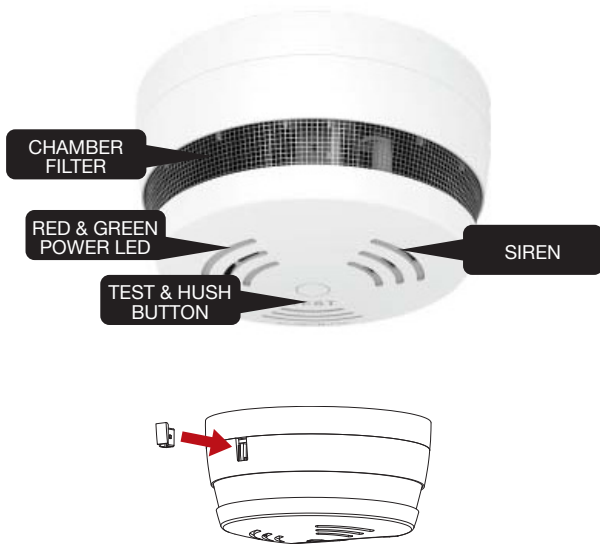

To remove the Safety Lock in future, you will require a flathead screwdriver and we advise to not be too forceful when removing.

ISSUE: The alarm is sounding, even though there is no smoke.

You can hush a CAVIUS alarm for 10 minutes by pressing the hush button located on the bottom surface of the alarm.

The alarm which was originally activated will be the only alarm that flashes red. You can hush each alarm individually. To silence them all at once – you can press the hush the button on the original activated alarm.

95% of false alarms occur due to either dust or bugs finding their way inside the chamber and scattering the optical light, which will activate the alarm.

FIX: Run a vacuum cleaner, with a brush attachment (if you have one) on the lowest setting, around the outside of the alarm's Chamber Filter (grey mesh). Do not open up the alarm.

ISSUE: The smoke alarm keeps beeping.

1 The alarm contains a Duracell lithium backup battery (CR2) that is replaceable. If the battery has been powering the alarm for long periods of time, this may cause the battery to go flat.

FIX: The battery needs replacing.

2 A power surge may also have affected the mains power supply to the alarm.

FIX: Take the alarm out of the base (you may need to remove the Safety Lock) and turn off the mains power for 10-15 seconds. Switch back on and then place the alarm back into the base.

78mm Battery Operated Smoke Alarm

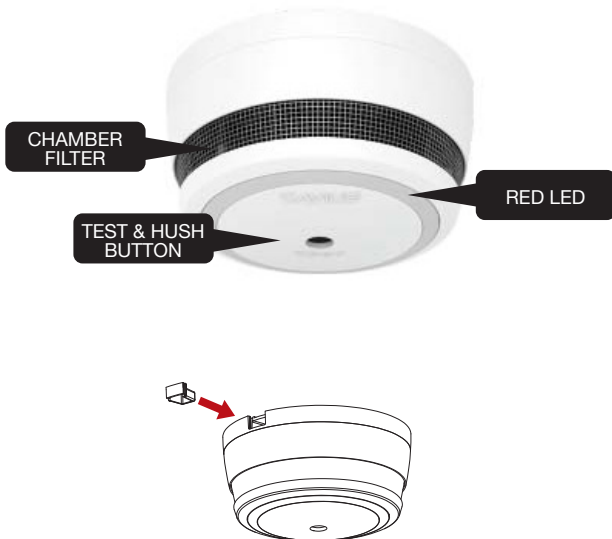

To remove the Safety Lock in future, you will require a flathead screwdriver and we advise to not be too forceful when removing.

ISSUE: The alarm is sounding, even though there is no smoke.

You can hush a CAVIUS alarm for 10 minutes by pressing the hush button located on the bottom surface of the alarm.

The alarm which was originally activated will be the only alarm that flashes red. You can hush each alarm individually. To silence them all at once – you can press the hush the button on the original activated alarm.

95% of false alarms occur due to either dust or bugs finding their way inside the chamber and scattering the optical light, which will activate the alarm.

FIX: Run a vacuum cleaner, with a brush attachment (if you have one) on the lowest setting, around the outside of the alarm's Chamber Filter (grey mesh). Do not open up the alarm.

ISSUE: The smoke alarm keeps beeping.

These alarms are fully activated when the red activation button, you will find this on the base of the alarm, is pressed down entirely. For the 10 Year battery model, this happens when clipped into the base. The red activation button may not be pressed down entirely.

FIX: Take the alarm out of the base by twisting anti-clockwise (you may need to remove the Safety Lock), Place back into the base by turning it clockwise, you should hear and feel a 'click'. Wait 10 seconds and then press the test button on the side of the alarm.

If the beeping continues, the base may need adjusting. Unscrew the mounting base just half a turn – easing off some of the tension.

If you encounter any further issues, please contact:

For any questions about the CAVIUS smoke alarms, please contact:

CAVIUS Australia Pty Limited

Ph: 07 3556 1441 | info@cavius.com.au | cavius.com.au